

CLIFF

CLIFFCON® 68

CLIFFCON68 IS AN IP68 RATED MULTIPIN CONNECTOR FOR WATERPROOF AND RUGGED APPLICATIONS.

FEATURES

- Panel hole cut-out size: 13mm
- IP68 for under water, outdoor and indoor when mated or with optional cap fitted
- CE & ROHS approval
- 2 to 9 gold-plated contacts (no 8 pin version)
- Sealing cap available for socket. Sold separately.

SPECIFICATION

Coupling Type	Threaded coupling
IP Rating	IP68
Material	Plastic Shell Nylon66, fire resistance:V-0
Insert material	PPS max temperature 260°C, fire resistance:V-0
Contact material	Brass with gold plating
Termination	Solder
Cable OD	5-8mm
Mating cycle	> 500
Temperature range	-25~+85°C
Insulation resistance	2000MΩ

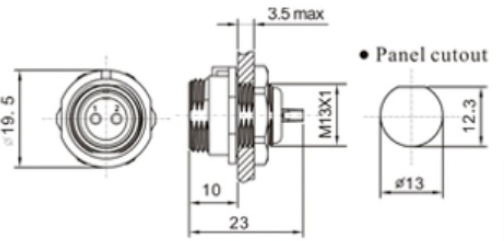
Picture	Description	Drawing
	Front Mount Male	

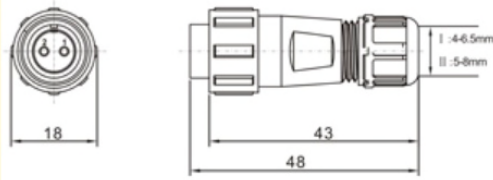
Picture	Description	Drawing
	Cable Connector Female	

BELTRONICA NUEVA DIRECCIÓN / NEW ADDRESS

Avenida de Somosierra, 22 - Naves E 6 y 7 - P. E. Inbisa I

San Sebastián de los Reyes - ES 28703 - Madrid

Teléfono / Phone: +34 916 381 331

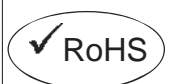

Contact arrangement and spec for solder termination.

Number of Contacts	2	3	4	5	6	7	9
Male contact face view							
Rated current (A)	13A	13A	5A	5A	5A	5A	3A
Contact diameter	Ø1.6 x 2	Ø1.6 x 3	Ø1 x 4	Ø1 x 5	Ø1 x 6	Ø1 x 7	Ø0.7 x 9
Rated voltage (AC, V)	250V	250V	200V	180V	125V	125V	125V
Test voltage (AC, V) 1 min	1500V	1500V	1500V	1000V	1000V	1000V	1000V
Contact resistance mΩ	2	2	5	5	5	5	10
Wire size mm ² / AWG	≤2 / 14	≤2 / 14	≤0.785 / 18	≤0.785 / 18	≤0.785 / 18	≤0.785 / 18	≤0.785 / 18

PART No.	DESCRIPTION	No PINS	CABLE OD
FM686802	CLIFFCON68 MALE PANEL SOCKET 2 PIN	2	N/A
FM686803	CLIFFCON68 MALE PANEL SOCKET 3 PIN	3	N/A
FM686804	CLIFFCON68 MALE PANEL SOCKET 4 PIN	4	N/A
FM686805	CLIFFCON68 MALE PANEL SOCKET 5 PIN	5	N/A
FM686806	CLIFFCON68 MALE PANEL SOCKET 6 PIN	6	N/A
FM686807	CLIFFCON68 MALE PANEL SOCKET 7 PIN	7	N/A
FM686809	CLIFFCON68 MALE PANEL SOCKET 9 PIN	9	N/A

PART No.	DESCRIPTION	No PINS	CABLE OD
FM686832	CLIFFCON68 FEMALE PANEL SOCKET 2 PIN	2	N/A
FM686822	CLIFFCON68 MALE OVERMOULD 2 PIN 5M	2	4.5mm

PART No.	DESCRIPTION	No PINS	CABLE OD
FM686812	CLIFFCON68 FEMALE PLUG 2 PIN	2	5-8mm
FM686813	CLIFFCON68 FEMALE PLUG 3 PIN	3	5-8mm
FM686814	CLIFFCON68 FEMALE PLUG 4 PIN	4	5-8mm
FM686815	CLIFFCON68 FEMALE PLUG 5 PIN	5	5-8mm
FM686816	CLIFFCON68 FEMALE PLUG 6 PIN	6	5-8mm
FM686817	CLIFFCON68 FEMALE PLUG 7 PIN	7	5-8mm
FM686819	CLIFFCON68 FEMALE PLUG 9 PIN	9	5-8mm

PART No.	DESCRIPTION	No PINS	CABLE OD
FM686800	CLIFFCON68 SOCKET CAP	N/A	N/A

PART No.	DESCRIPTION	No PINS	CABLE OD
FM686842	CLIFFCON68 MALE INLINE PLUG	2	5-8mm
FM686843	CLIFFCON68 MALE INLINE PLUG	3	5-8mm



Socket with cap fitted.



Male Inline Plug
2 Pin and 3 Pin currently available.
Other models on request.

2 Pin Female Panel Socket

NEW



Part No: **FM686832**

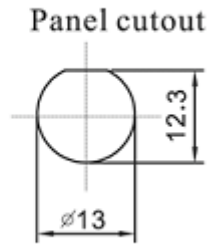
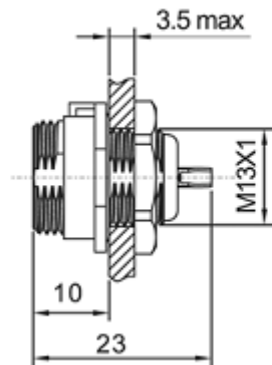
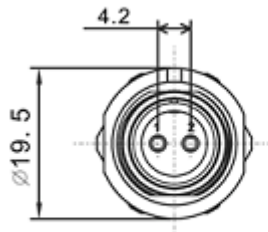

2 Pin Male Overmould Plug with 5m Cable

NEW



Part No: **FM686822**

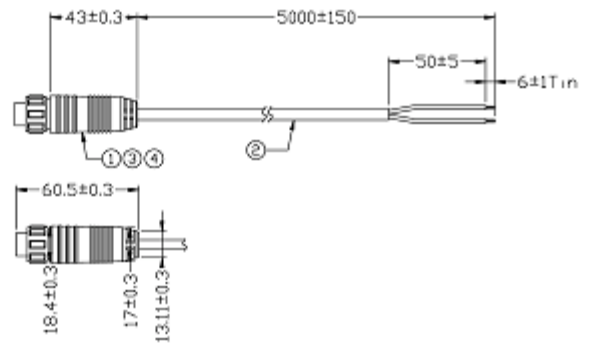
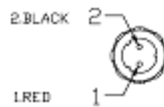

Cable Spec
Unshielded UL2464 #20*2C
(26/0.16BC*1.46*2C) O/D Ø4.5mm

BELTRONICA NUEVA DIRECCIÓN / NEW ADDRESS

Avenida de Somosierra, 22 - Naves E 6 y 7 - P. E. Inbisa I

San Sebastián de los Reyes - ES 28703 - Madrid

Teléfono / Phone: +34 916 381 331