

LOCK SWITCH

SKL

SKL LOCK SWITCH

ELECTRICAL & MECHANICAL SPECIFICATION

Switch Rating:	0.5A @24V ac/dc resistive	Life:	>10,000 Cycles
Proof Voltage:	1000V ac 1 minute (Initial)	Operating Temperature:	-20°C to +65°C
Insulation Resistance:	>500MΩ @ 500V dc (Initial)	Contact Resistance:	>50mΩ max

FEATURES

Single pole dual throw	Radial cylinder with 4 pin tumblers	Same key or 10 differ key options -low security
Front panel mount	Bright chrome plated zinc alloy die cast housing	Key inserted / removed in one or both positions
Stainless steel capped bezel		90° indexing Brass keys nickel plated

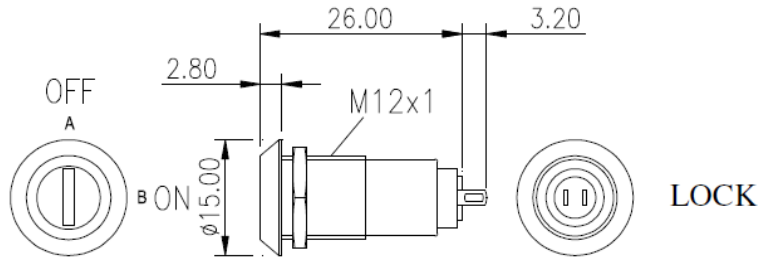

ORDERING CODE

ORDERING CODE	KEY	KEY WITHDRAWAL	KEY TRAVEL	SWITCH OFF - ON
SKL-12-A-S-2	SAME	A & B	90°	
SKL-12-B-S-2	SAME	A ONLY	90°	
SKL-12-A-D-2	DIFFER	A & B	90°	
SKL-12-B-D-2	DIFFER	A ONLY	90°	

Same Key Ref Key 134 (SKL)

PANEL PIERCING DETAILS

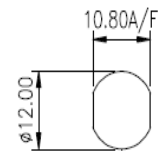

BELTRONICA

NUEVA DIRECCIÓN / NEW ADDRESS

Avenida de Somosierra, 22 - Naves E 6 y 7 - P. E. Inbisa I

San Sebastián de los Reyes - ES 28703 - Madrid

Tel / Phone: +34 916 381 331 - comercial@beltronica.es