

ROTARY SWITCH MODULE SIGNAL

MS2000 ROTARY SWITCH MODULE

ELECTRICAL & MECHANICAL SPECIFICATION

| | | | |
|-------------------------------|----------------------------|-------------------------------|-----------------------------|
| Switch Rating: | 20mA @ 24V dc | Life | >50.000 |
| Proof Voltage | 2.5kV (Initial) | Operating Temperature: | -25°C to +85°C |
| Insulation Resistance: | >999MΩ @ 500V dc (Initial) | Terminal Material: | Brass CZ108, Sn Plated |
| Contact Resistance: | <10MΩ (Initial) | Tag Panel: | SRBP |
| Contact Gap: | >2.5mm | Switch Chamber: | Polyamide 6.5 G.F. V0 Rated |
| Contact Material: | Ag CdO + Au Plated | | |

FEATURES

| | | | |
|-------------------|----------------|-------------------|--------------|
| 2 pole on-off | Solder | Mounting options: | Push Button |
| 2 pole changeover | Optional stops | Non-Bracketed | modules also |
| | Made in the UK | Bracketed | available |
| | | Plate | |

Mounting Bracket

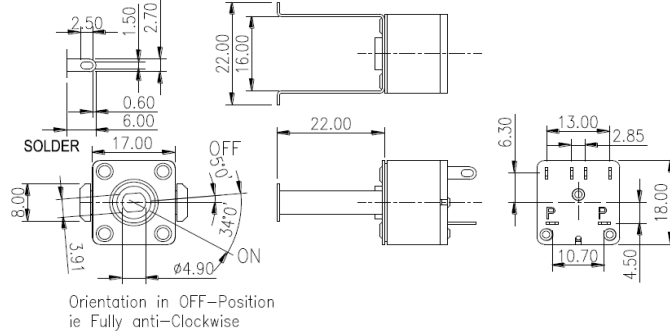

Mounting Plate

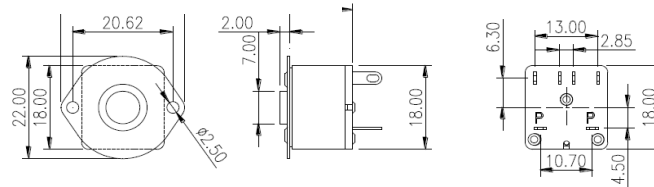

ORDERING CODE

| 2 POLE OFF- ON (NORMALLY OPEN) | | |
|-----------------------------------|----------------|----------------|
| | PLATE | BRACKET |
| ORDERING CODE | MS2215 90° SOL | MS2212 90° SOL |

| 2 POLE CHANGEOVER | | |
|----------------------|----------------|----------------|
| | PLATE | BRACKET |
| ORDERING CODE | MS2214 90° SOL | MS2211 90° SOL |

BELTRONICA NUEVA DIRECCIÓN / NEW ADDRESS

Avenida de Somosierra, 22 - Naves E 6 y 7 - P. E. Inbisa I

San Sebastián de los Reyes - ES 28703 - Madrid

Tel / Phone: +34 916 381 331 - comercial@beltronica.es